

Thank you for choosing Ripper clipless pedals for your mountain bike.

Proper installation is crucial for optimal performance and compliance with our warranty policy.

Follow these step-by-step instructions and illustrations carefully. Our product offers superior grip, durability, and performance. Enjoy your new pedals and happy riding!

## TOOLS REQUIRED

- Hex key 3mm
- Hex key 8mm
- Socket wrench 4mm

## CONTENTS

- Pedals ..... 1SET
- Traction pins ..... 16 PCS
- Cleat kit ..... 1SET
- Socket wrench 4mm ..... 1PC

## PEDAL INSTALLATION

1. Identify the left and right side axles. The left-side axle has a lathed mark on the axle head, whereas the right-side pedal has no markings.
2. Use the 4mm socket wrench to install the traction pins according to your preference.

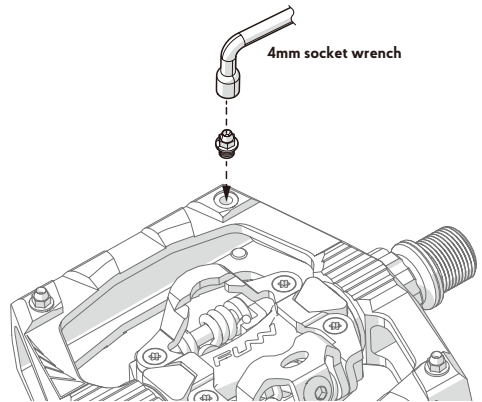
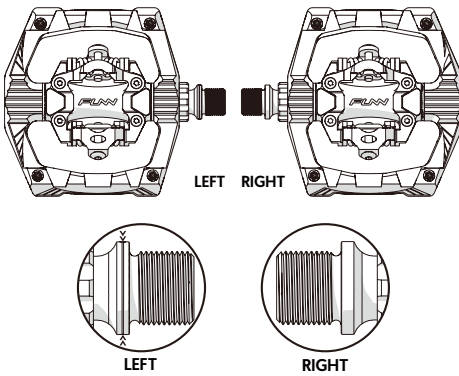

3. Lightly lubricate the axle threads with anti-seize grease. Thread the axle into the crank hole with your fingers first. Please follow the illustrated directions for tightening the left and right side pedals.
4. Insert a 8mm hex key to further tighten the screw to 34Nm (300 lb-in) torque and avoid excessive force.

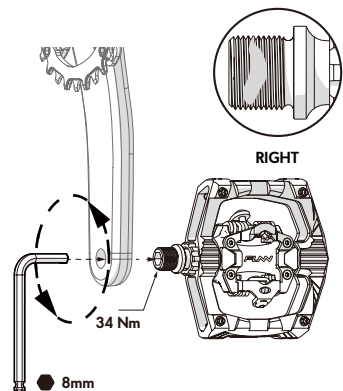
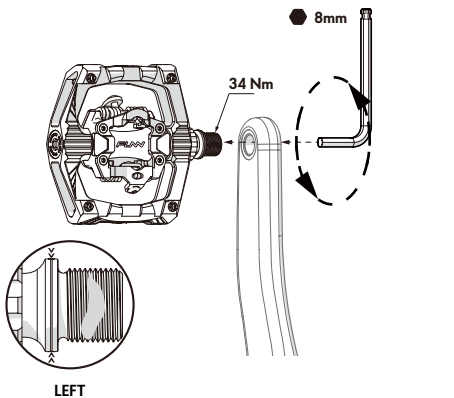

## INSTALL CLEATS TO CYCLING SHOES

Apply a thin layer of grease to the cleat bolt threads, then loosely attach the cleat bolts and washers to the shoe soles using the 4mm hex key.

Position the cleat so that it aligns directly beneath the center of the ball of your foot. Vertical adjustment can be achieved through the slots in the shoe's sole. For horizontal alignment, utilize the interplay between the cleat washer and the cleat itself.

Secure the cleat with a torque of 5-8Nm (44-70lb-in), being careful to avoid applying excessive force. The cleat's position can be adjusted according to personal preference following initial trial rides. Finding the ideal cleat configuration may require several rides to achieve perfection.

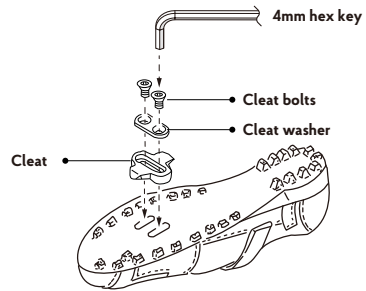
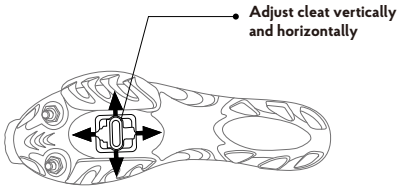

## ENGAGE AND DISENGAGE

To engage cleated shoes with the pedals, align the cleat between the front and rear bindings while applying downward pressure.

Disengage by twisting the heel outward (away from the bicycle). If necessary, the cleat can also be released by twisting the heel inward.

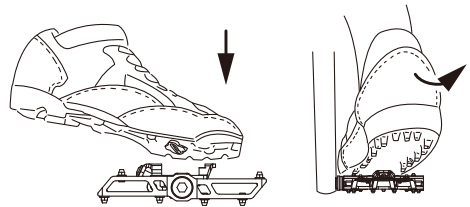

## BINDING TENSION ADJUSTMENT

The tension adjuster is positioned on the rear binding. To adjust the binding tension, utilize a 3mm hex key to turn the tension adjuster.

Increase tension by turning clockwise for a firmer shoes binding, albeit with more resistance in engaging and disengaging.

Decrease tension by turning counter-clockwise for a looser shoes binding, offering easier engagement and disengagement.

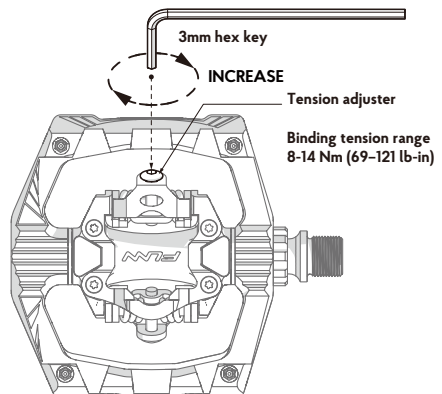

**FLNN**

**RIPPER  
PEDAL**



**Bearing / Axle Replacement**

**( Disassembly )**



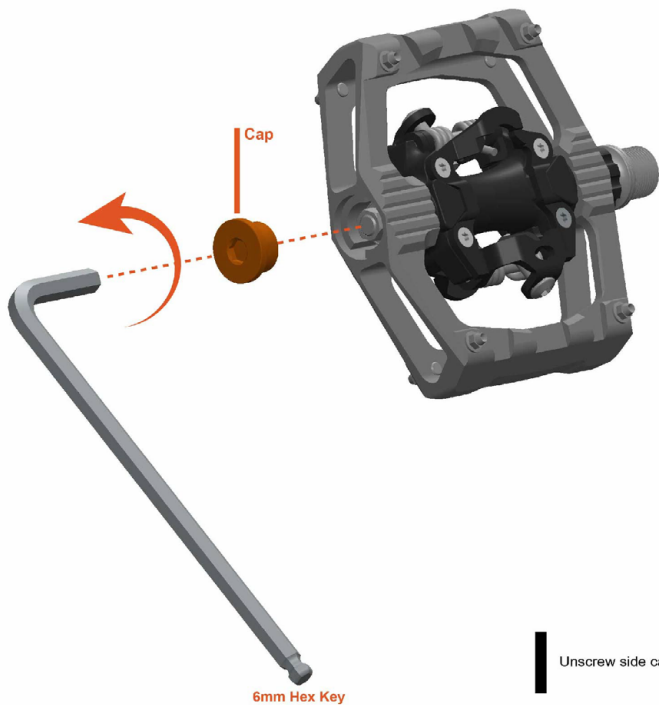

Unscrew side cap with 6mm hex key.

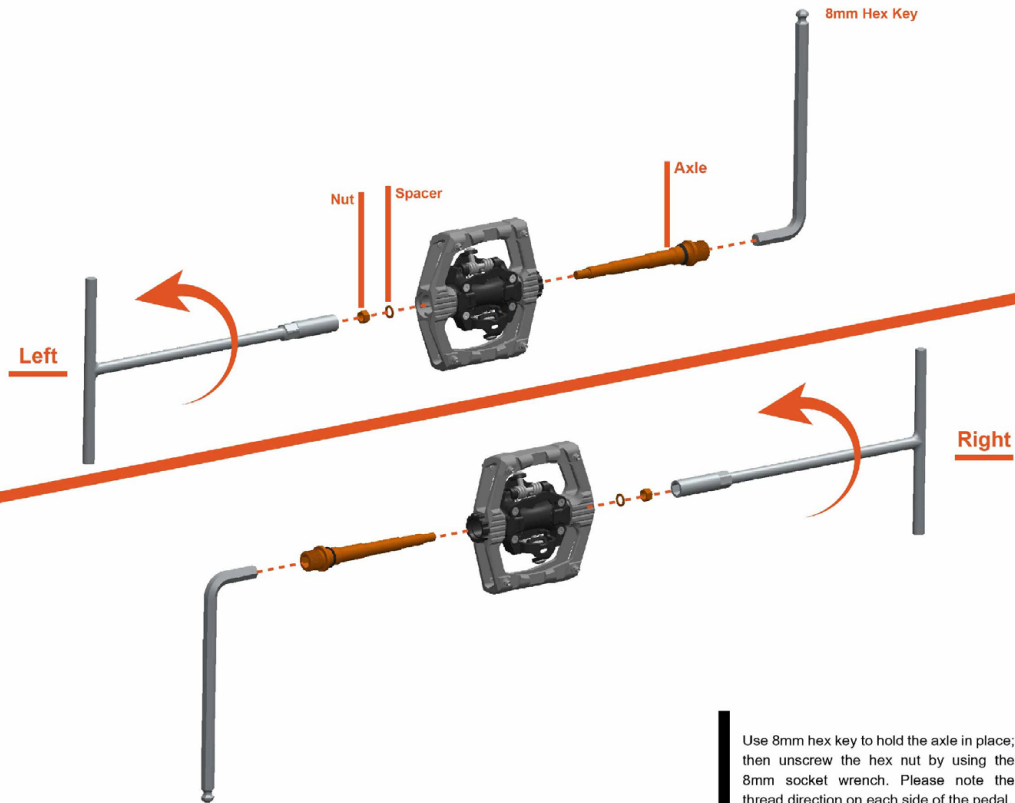

Use 8mm hex key to hold the axle in place; then unscrew the hex nut by using the 8mm socket wrench. Please note the thread direction on each side of the pedal.

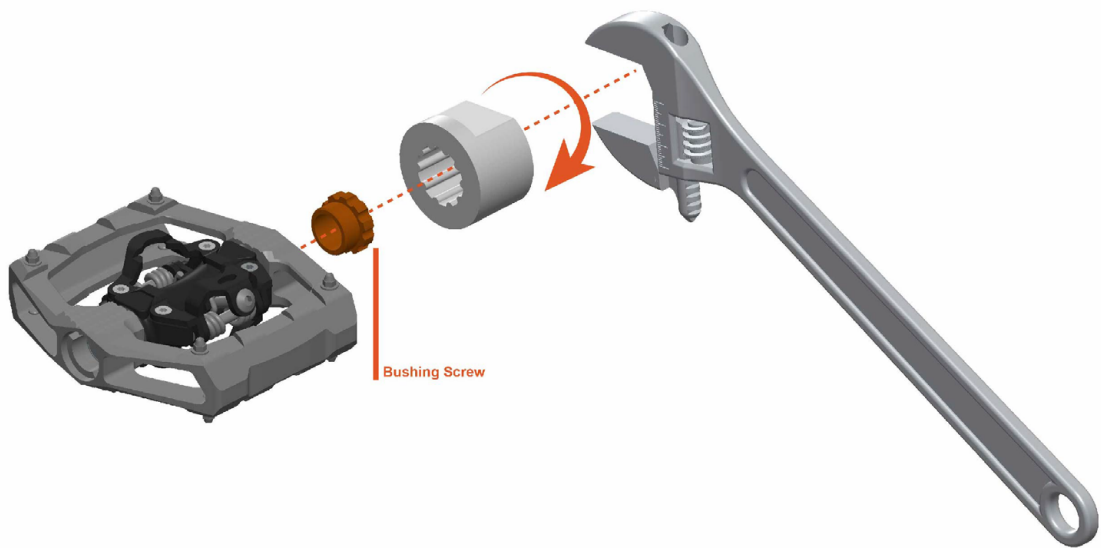

Unscrew the bushing screw with the adjustable wrench included in the axle cap tool or Shimano TL-PD40 tool.

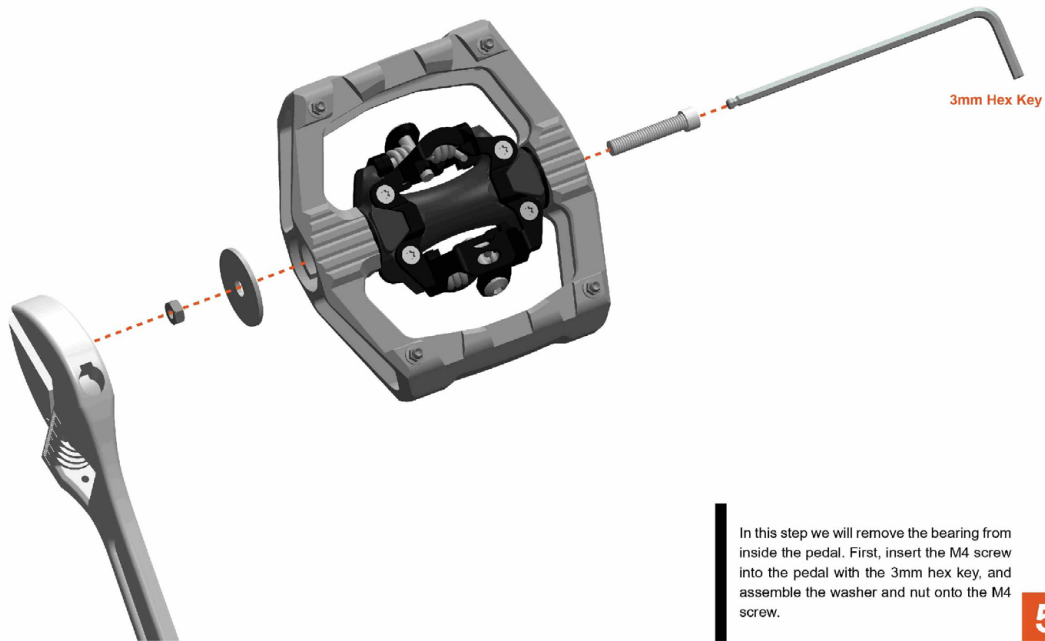

In this step we will remove the bearing from inside the pedal. First, insert the M4 screw into the pedal with the 3mm hex key, and assemble the washer and nut onto the M4 screw.



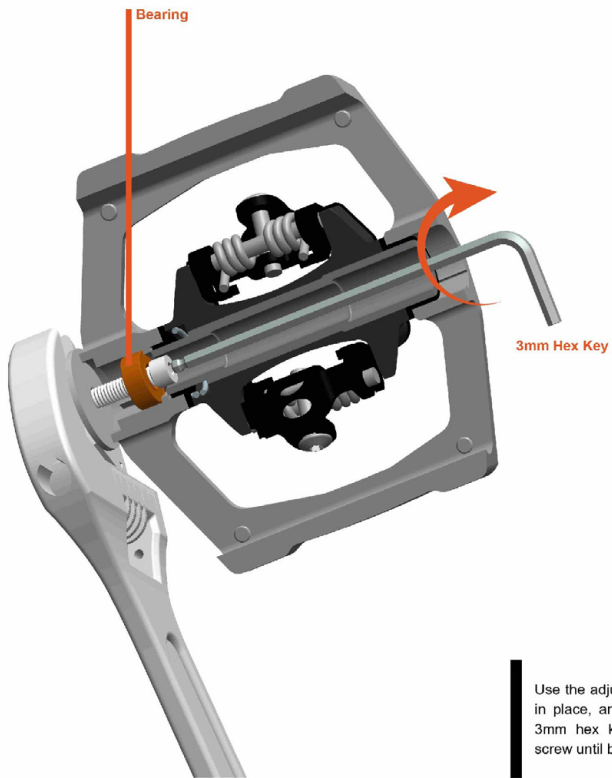

Use the adjustable wrench to hold the nut in place, and tighten the M4 screw with 3mm hex key. Keep tightening the M4 screw until bearing gets pushed out.

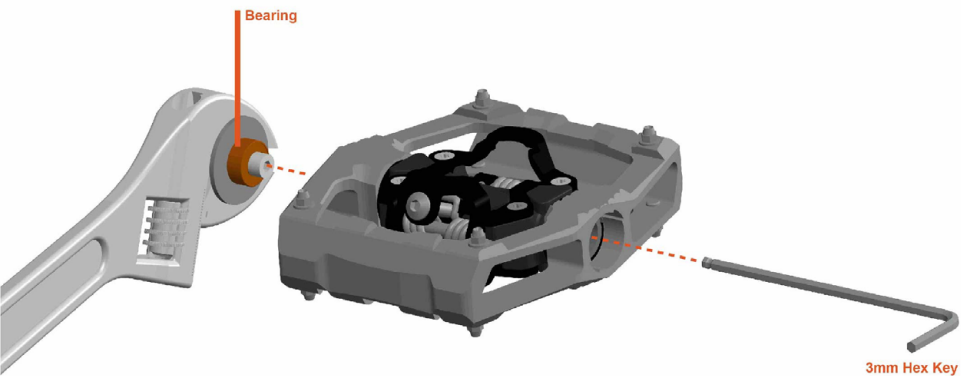

Remove the old bearing.

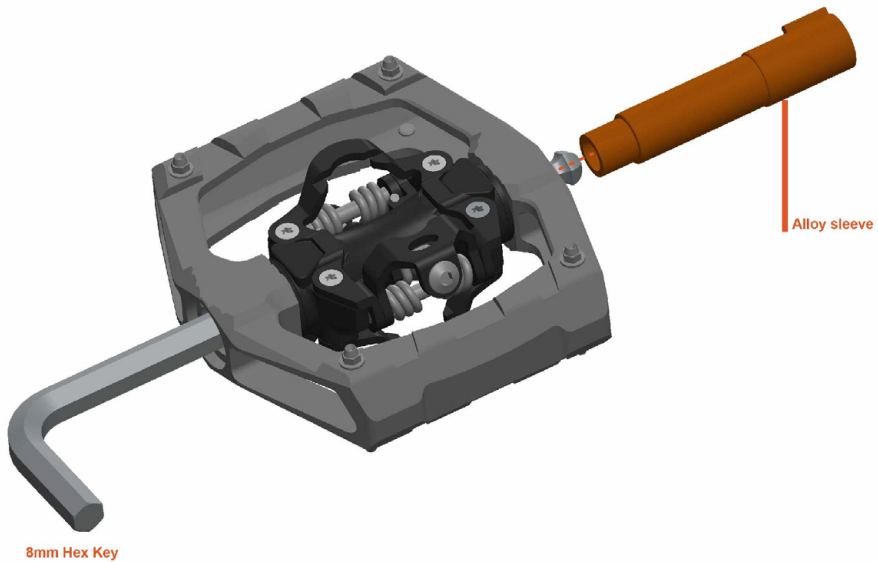

Insert 8mm hex key to gently push out the alloy sleeve.



Gently detach pedal body from pedal cage. Do not use excessive force and pay special attention not to damage or loose the side spring.

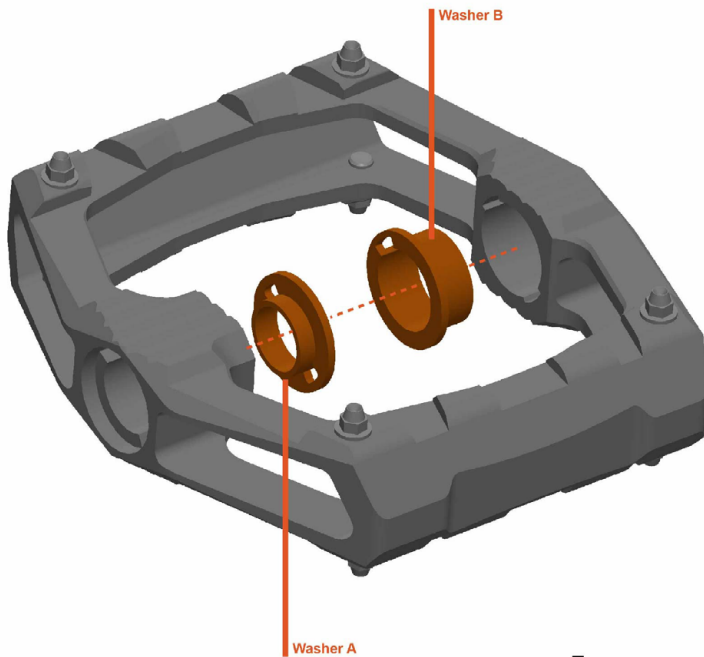

Remove old washers from pedal cage as indicated by drawing.

**FLNN**

**RIPPER  
PEDAL**



**Bearing / Axle Replacement**

**( Assembly )**

Left

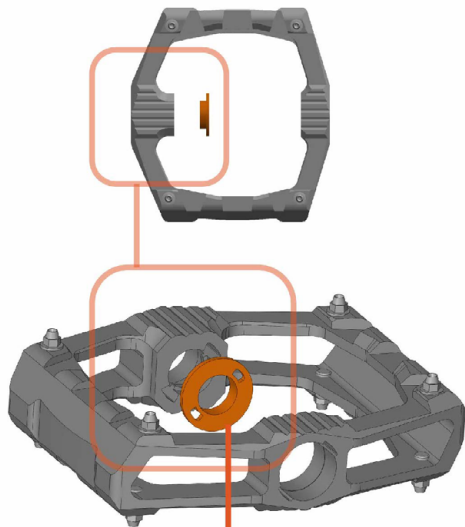

Washer A

Right

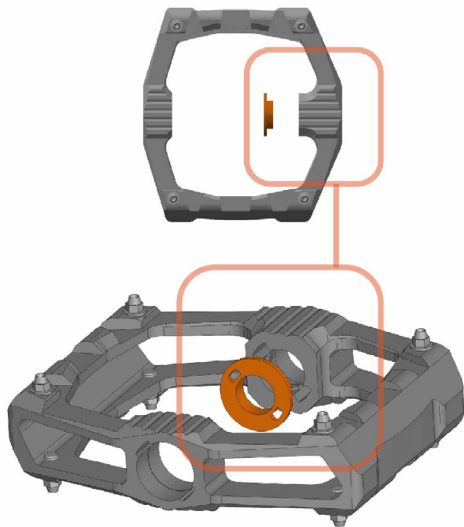

Install washer A according to each side as shown in the drawing. Make sure the slots on the washer align with slots on the pedal cage.

Left

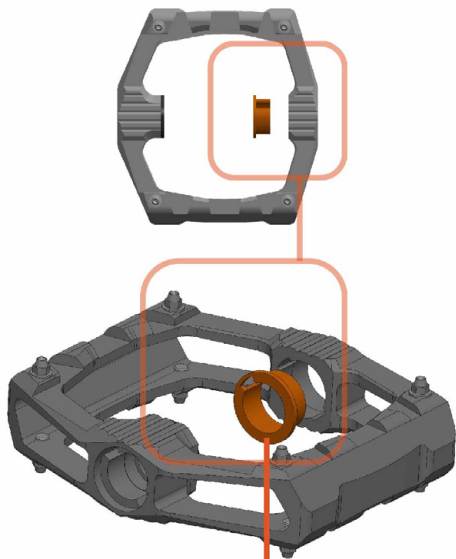

Washer B

Right

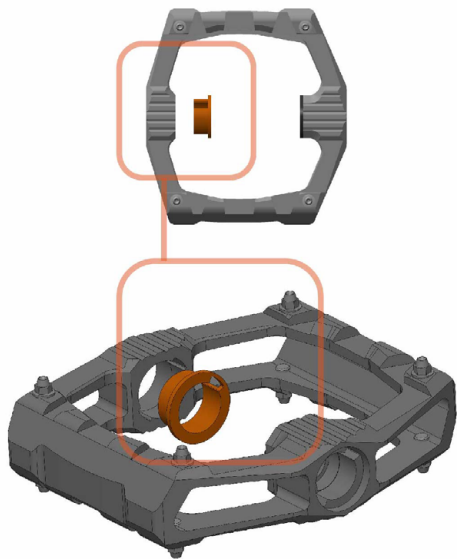

Install washer B according to each side as shown in the drawing. Make sure the slots on the washer align with slots on the pedal cage.



Left

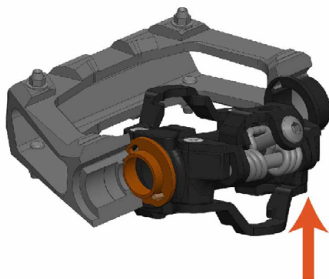

Right

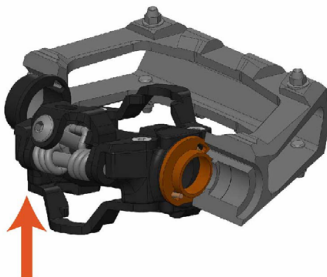

Install the pedal body by first inserting the pin on the side spring into the slot in washer A. Once the pin is in place, push the pedal body into the cage.

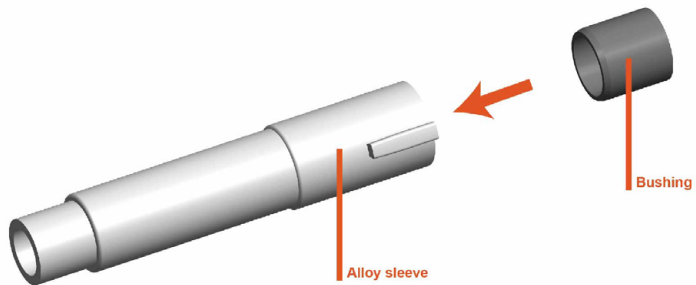

Push the bushing into the alloy sleeve.

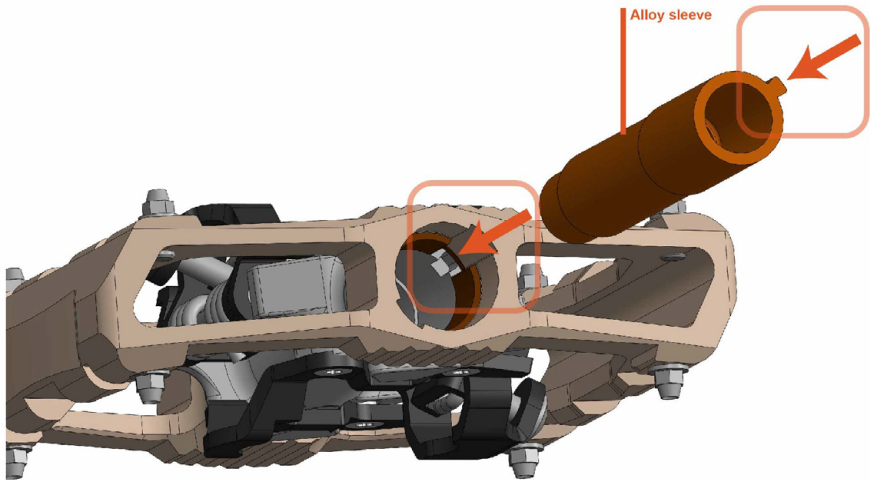

1. Once the pedal body is inside the cage, you will notice a slot that exists in both the cage and the body. You will also see a protruding section on the side of the alloy sleeve.
2. Align the slot by holding the body and cage in place, and insert the alloy sleeve, so that the protruding section slides into the slot of both the cage and the body.
3. Make absolutely sure that the protruding section bottoms out in the pedal cage slot.

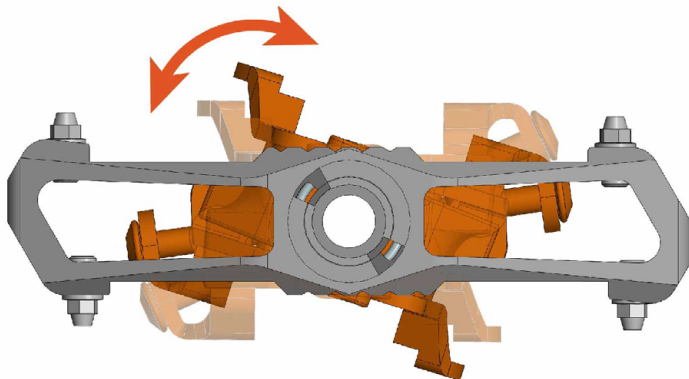

Rock the main body and check if it rotates smoothly.

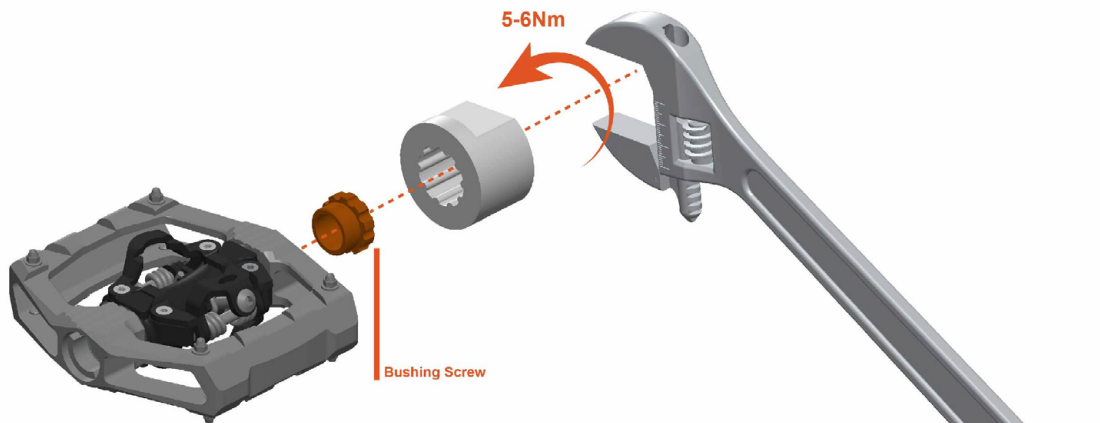

Install the bushing screw with axle cap tool.

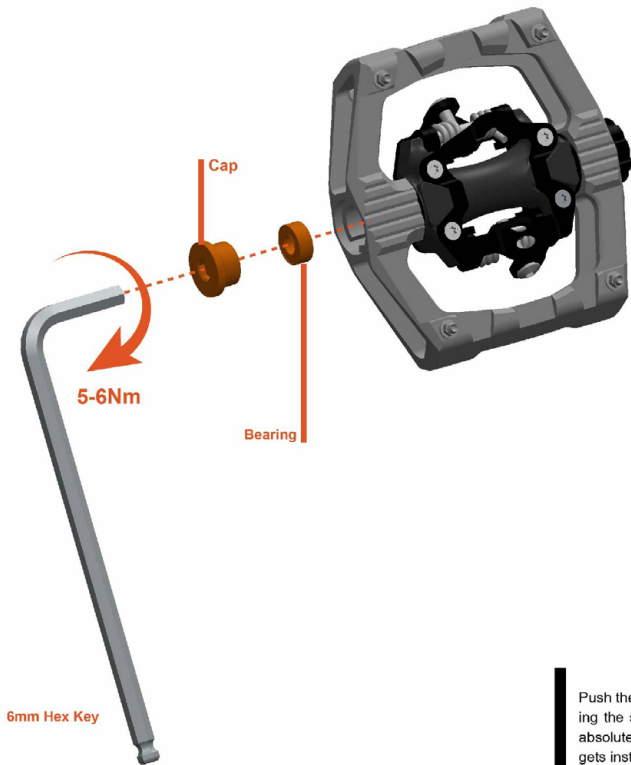

Push the bearing into the pedal by tightening the side cap. Make sure the side cap absolutely bottoms out so that the bearing gets installed correctly.

Unscrew side cap and check if the bearing has bottomed out in the bearing seat. If not repeat the last step until it has.

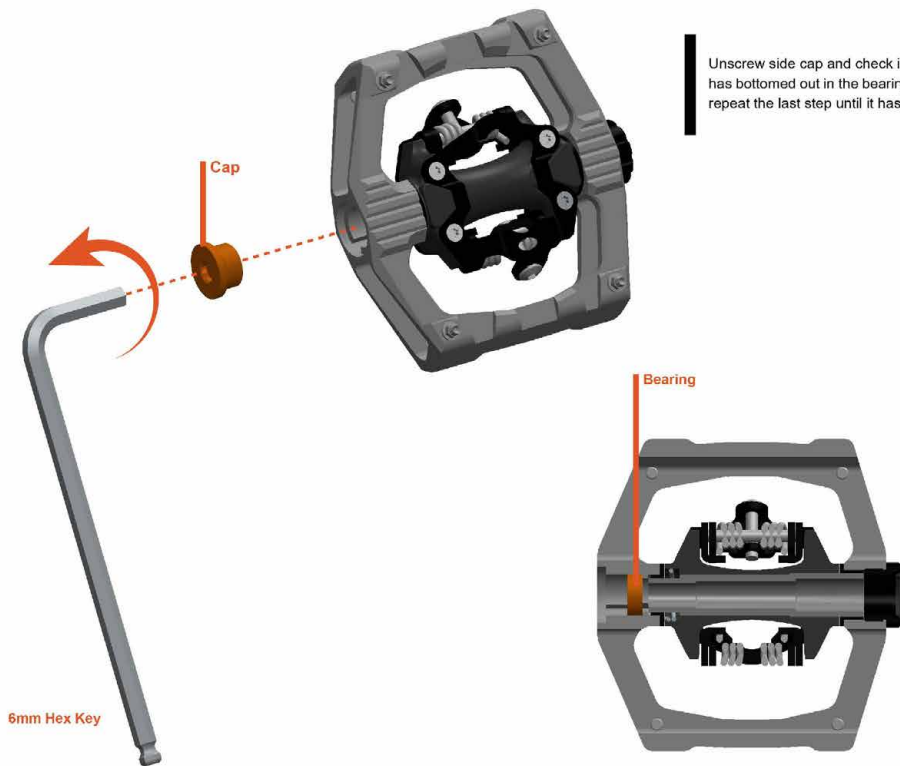

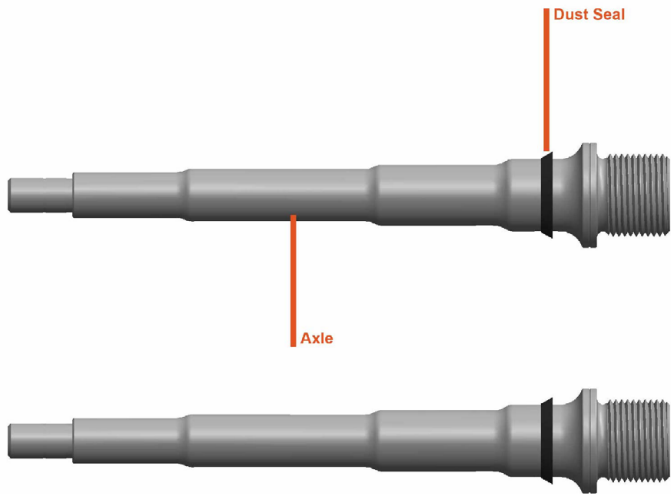

Install dust seals onto the pedal axles and lightly grease the axle.



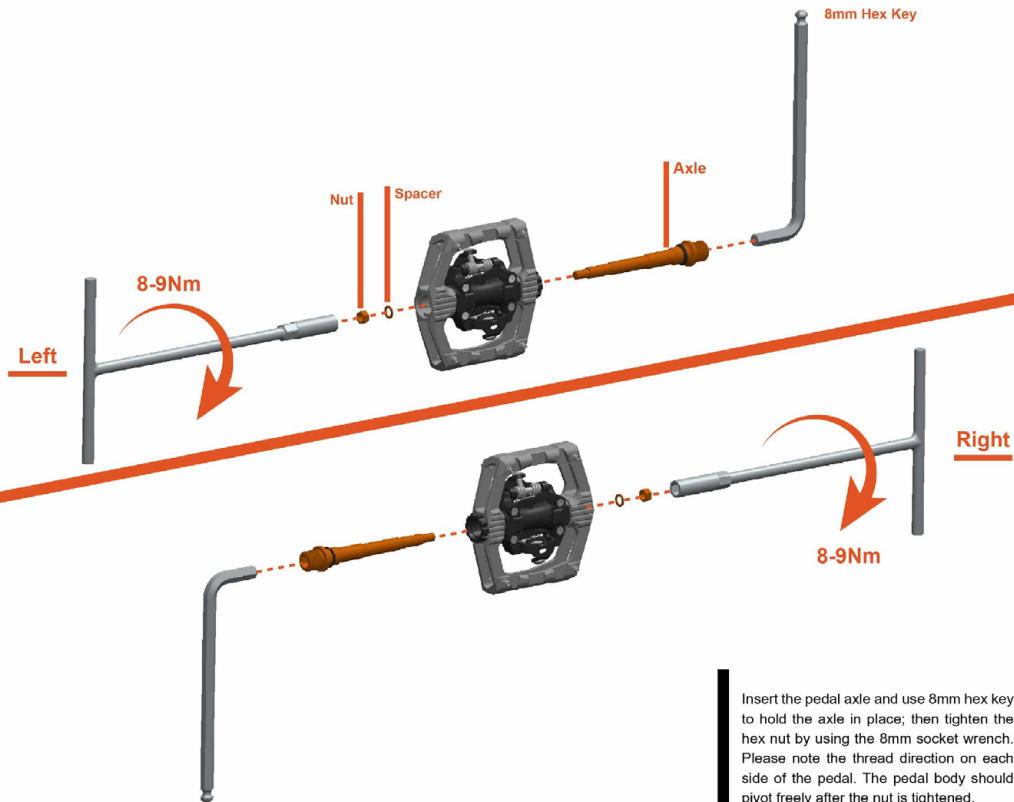

Insert the pedal axle and use 8mm hex key to hold the axle in place; then tighten the hex nut by using the 8mm socket wrench. Please note the thread direction on each side of the pedal. The pedal body should pivot freely after the nut is tightened.

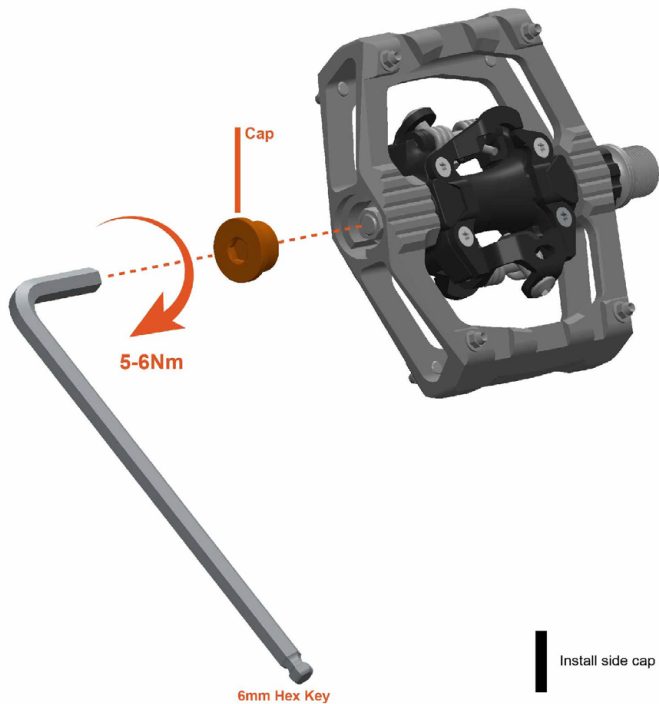

Install side cap with 6mm hex key.